

Anthro Corporation LAPTOP STORAGE CART



The only UL Approved Laptop Storage Cart on **BOTH** the electrical and the cabinet.

Anthro introduced the first generation of Laptop Storage Carts in 2000. Not one to rest on our laurels, we've taken all of your suggestions to heart and improved our original design. We are proud to introduce our newest version of the Anthro Laptop Storage Cart, available in 20 and 30 unit models.



Features:



BUILT IN POWER

A UL approved 110 volt electrical outlet built-in to every storage bay allows you to charge all of your laptops at the same time. It's easy and safe for you to "power up"—no daisy chained power strips to deal with.

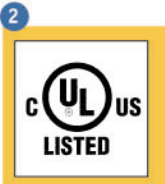

SAFETY

Anthro is extremely safety conscious and took the extra steps to make sure **BOTH** the electrical and cabinets were UL approved. This means that in the event a short occurs, our cabinets will not become electrically "hot" and shock you.

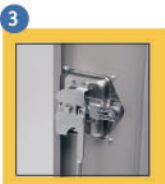

SECURITY:

Reinforced steel doors have a two point keyed locking system to keep your laptops safe. The T-handle is recessed so it does not stick out and catch on door frames and corners.



CABLE MANAGEMENT

Manage your laptops' cables easily. Each storage bay shelf has been designed with a slot to be used in combination with supplied velcro cable ties. Thread the velcro cable tie through the slot located at the front of each shelf. Wrap the velcro tie around the bundled cables and adapter to secure them to each shelf.

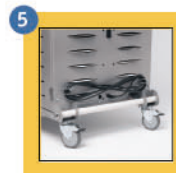

ONLY ONE WALL OUTLET NEEDED

All you need is one outlet to charge all of your laptops. A single 12' power cord on the outside of the Cart gives you enough length to move your Cart where you need it. A shark fin cable wrap at the bottom of the Cart gives you a handy place to wrap your excess cord.



VENTILATION

Sculpted vents on both sides and the door encourage air to circulate around your equipment.



EASY MOBILITY AND STEERING

The Cart comes standard with four silent 5" soft rubber, heavy duty casters. Two casters are locking and two have a directional swivel lock to make steering a snap. You can also move the Cart easily over uneven or rough surfaces using the two large diameter handles on each side.

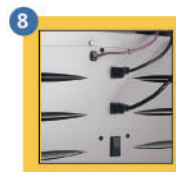

EXTERNAL OUTLETS FOR PERIPHERALS/LAN CONNECTION

Place your projector or hardware on the top of the Cart and use the two 110 volt convenience outlets located near the top of a side panel to power your equipment. An integrated two-way lighted switch gives you the option of powering your laptops or running your external equipment. Also included is a network cable receptacle so you can connect to your local area network.

www.uptime4u.com
UPTIME BUSINESS PRODUCTS
 800-222-1440
 Email: uptime@uptime4u.com

LAPTOP STORAGE CART COMPARISON

FEATURE:	ANTHRO	BRETFORD	DATAMATION
BUILT IN POWER?	YES. UL approved factory installed built-in electrical outlets located in the REAR of the shelf. <i>Note:Rear placement allows you to keep your adapters plugged in at all times without having to unplug them each time you load and unload your Cart.</i>	YES. UL approved customer installed electrical outlets located in the FRONT of the shelf.	NO. Daisy-chained power strips.
OVERLOAD PROTECTION (30 units and larger)	YES. The 30 unit comes standard with a free of charge built-in timing device that automatically switches the AC power supply from one side of the Cart to the other when charging.	YES. Available as an accessory for an additional fee.	NO
WARRANTY?	Lifetime Warranty on the cabinet, 1 year on electrical.	3 years on the cabinet, 1 year on electrical.	3 years on the cabinet and electrical.
ASSEMBLY REQUIRED?	NO. Ships assembled.	YES. Ships unassembled.	NO. Ships assembled.
LEAD TIME?	3 business days.	4 weeks.	5 business days.
SAFETY TESTED?	YES. See FAQ's below for further details.	Information not available.	Information not available.

FREQUENTLY ASKED QUESTIONS (FAQ'S)

Q I notice that you mention that your Laptop Storage Cart is UL tested and certified as approved on the electrical AND the cabinet to the UL standards of Industrial Technology Equipment. Carts made by other manufacturers only list the electrical as UL approved. What's the difference?

A Anthro is extremely safety conscious and we took the extra steps to make sure our Cart "cabinets" were also UL approved. This means that in the event a short occurs, our cabinets will not become electrically "hot" and shock you. The Cart was examined in it's entirety for safety. A battery of tests were performed on the Cart including Stability Tests, Impact Tests, Electric Strength Tests, Sharp Edge Tests, Enclosure Push Tests, and Strain Relief Tests.

Q What is the weight of the Carts when empty? Weight with a shipping box?

A The 20 unit weighs 200 lbs. when empty. The shipping weight is 246 lbs. The 30 Unit weighs 275 lbs. when empty. The shipping weight of the 30 Unit is 334 lbs.

Q What are the dataports used for?

A If you use a wireless network hub like an Airport, you can set the hub on the top of the Cart and connect your local area network (LAN) cable to the RJ45 jack on the bottom of the Cart and connect the wireless hub to the port located at the top of the Cart.

DIMENSIONS AND PART NUMBERS:

20 Unit (Inside Storage Bay Dimensions: 15.5"w x 12"d x 3"h)

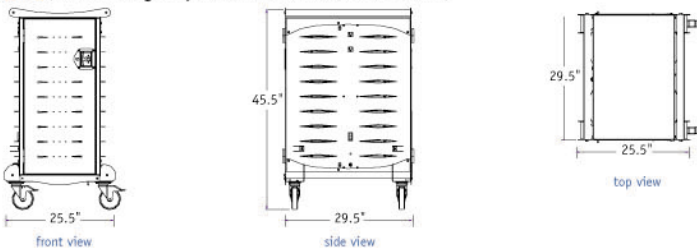

30 Unit (Inside Storage Bay Dimensions: 16"w x 12"d x 3"h)

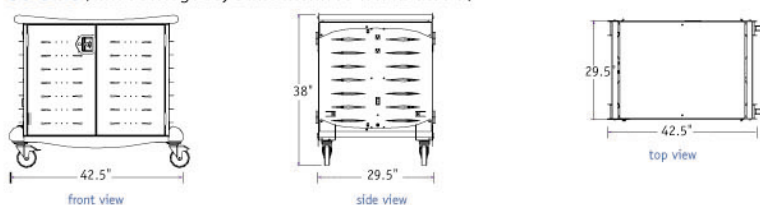

Part Numbers:

- 20 Unit: LTSC20WH/SM
- 30 Unit: LTSC30WH/SM

Color:
Silver Metallic colored Metal with White Shelving and Handles.

www.uptime4u.com
UPTIME BUSINESS PRODUCTS
800-222-1440
Email: uptime@uptime4u.com